



350 Regulators Installation and Maintenance

MASTER PNEUMATIC, INC.

6701-18 Mile Rd. | Sterling Heights, MI 48314 | Phone: (586) 254-1000 | Fax: (586) 254-6055 | Email: mp@masterpneumatic.com

MJF 10-24-13
ECN (4904)

SAMPLE PRODUCT NUMBERS:

R350-2
R350-3
R350-4

THANK YOU!

You have just purchased a quality Regulator from Master Pneumatic.

With care in its installation and maintenance, you can expect it to have a long and economical service life. Before you go any further, please take a few minutes to look over this information, then save it for future reference and for the useful service information it contains.



Installation & Operation Procedures

NOTE: Read Warning Stuffer STU-A019 included in box with product before proceeding.

INSTALLATION:

1. Depressurize and lockout air pressure.
2. Upstream pipes must be free of excessive dirt and liquids.
3. Install the Regulator as near as possible to the device it is to serve.
4. Install the Regulator so that air flows in direction of arrow Label on the Regulator.
5. The Regulator has gauge ports on both sides of the head. It is necessary to install a pressure gauge or pipe plugs into each port before operating.
6. Regulator should be installed upstream of any Lubricator or Valve in the airline.
7. Installing downstream of a general purpose M/P Filter with standard 5 micron filter element will insure a supply of clean air.
8. If installing using modular clamp connections A118-105 or A118-105M, torque screws 30-40 in-lbs.

OPERATION:

1. When adjusting pressure setting, always reset from a pressure lower than the final desired setting. For example, lowering pressure from 100 psi to 50 psi should be done by decreasing pressure to 30 psi then increasing to 50 psi.
2. To increase pressure: Pull out on Adjusting Knob (#10), turn clockwise.
To lower pressure: Pull out on Adjusting Knob (#10), turn counter-clockwise.
3. Push in on Adjusting Knob (#10) to lock in place.

TO CLEAN OR REPAIR:

1. Depressurize and lockout air pressure.
2. Reduce spring load to zero pull out on Adjusting Knob (#10), turn counter-clockwise.
3. Remove the Dome (#8) by unscrewing it counter-clockwise.
4. The Diaphragm Assembly (#4) can now be removed.
5. Visually inspect Diaphragm Assembly (#4) for defects. If necessary replace.
6. Remove the Regulator Cap (#1) by turning counter-clockwise.
7. The Valve Stem Assembly (#3) can now be removed.
8. Visually inspect Valve Stem Assembly (#3) for defects. If necessary replace.
9. When re-assembling, be sure all o-rings are correctly located. Lubricate o-rings with Lithium grease. Spacer (#5) MUST be between Diaphragm Assembly (#4) and Dome (#8). Torque Dome (#8) 200 in-lbs.
10. If the Regulator cannot be repaired by cleaning with soap and water the parts should be replaced.



350 Regulators Installation and Maintenance

MASTER PNEUMATIC, INC.

6701-18 Mile Rd. | Sterling Heights, MI 48314 | Phone: (586) 254-1000 | Fax: (586) 254-6055 | Email: mp@masterpneumatic.com

Section View

KEY	DESCRIPTION
1	Regulator Cap
2	Regulator Head
3	Valve Stem Assembly (valve, stem, seal & two o-rings)
4	Diaphragm Assembly (diaphragm, holder & washer)
5	Spacer
6	Panel Mount Nut (optional)
7	Main Spring
8	Dome
9	Adjusting Screw Assembly (screw & nut)
10	Adjusting Knob

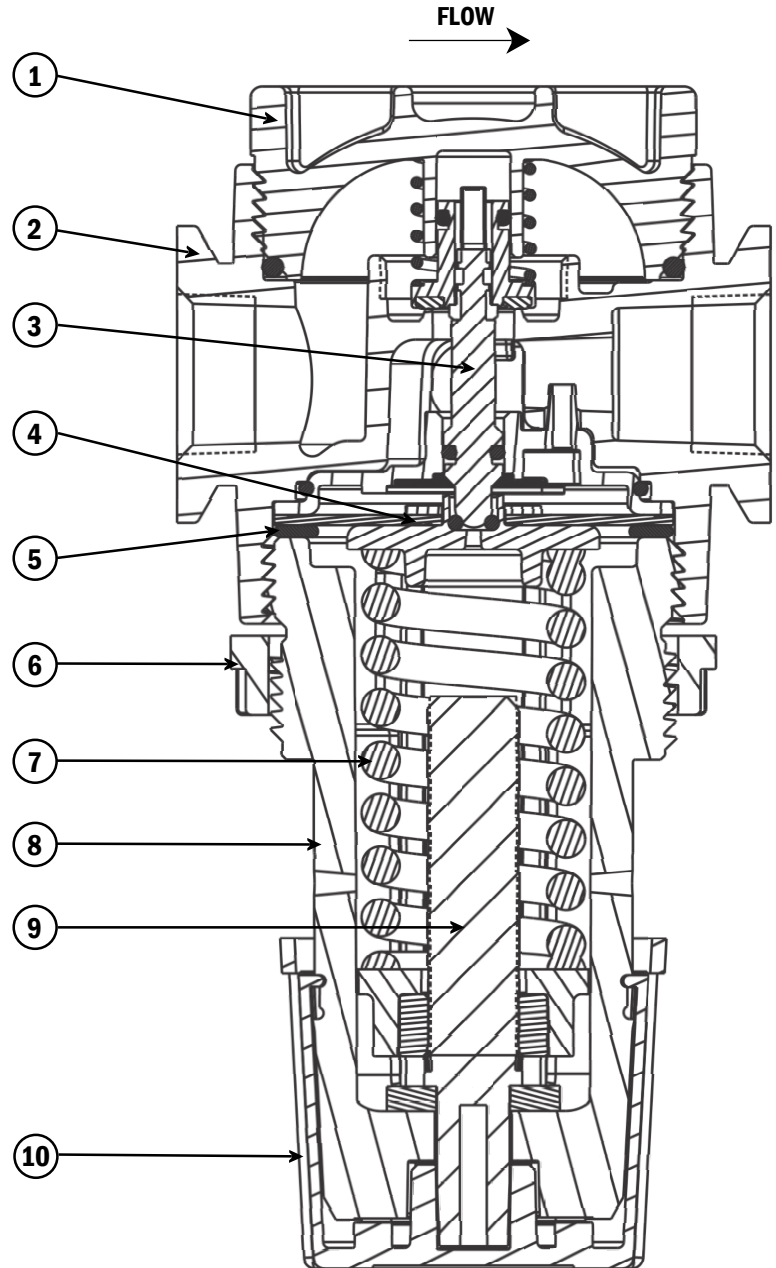



350 Regulators Installation and Maintenance

MASTER PNEUMATIC, INC.

6701-18 Mile Rd. | Sterling Heights, MI 48314 | Phone: (586) 254-1000 | Fax: (586) 254-6055 | Email: mp@masterpneumatic.com

MJF 10-24-13
ECN (4904)

Replacement Parts and Mounting Accessories

PART NUMBER	DESCRIPTION
Assembly Kits	
A127-08	Regulator Cap Assembly Kit (Cap, O-Ring & Spring)
A60R-11	Valve Stem Assembly (Valve, Stem, Seal, Spring & O-rings)
A127-05	Diaphragm Assembly Kit (Diaphragm Assembly, Spacer & O-Ring)
A127-05A	Diaphragm Assembly Kit Non-Relieving (Diaphragm Assembly Non-Relieving, Spacer & O-Ring)
A127-07P	Dome Assembly Kit with Panel Mounting Nut (Spacer, Panel Mount Nut, Dome, Spring rest, Adjusting Screw Assembly and washer, Adjusting Knob)
Mounting Brackets and Mounting Nuts	
127-11	Panel Mounting Nut
A127-11	Panel Mount Nut and Mounting Bracket
KA37-68	Gauge Port Mounting Bracket with Stud
KA37-68L	Gauge Port extended Mounting Bracket with Stud
A118-103	Modular Bracket and Screw for adding bracket to existing connecting clamps
A118-105M	Modular Connections and Bracket Kit (Modular connecting clamps, o-ring, screws and bracket)
UMB-2	Bracket for 1/4" piped units (U-bolt, bracket, nut and locking washer)
UMB-3	Bracket for 3/8" piped units (U-bolt, bracket, nut and locking washer)
UMB-4	Bracket for 1/2" piped units (U-bolt, bracket, nut and locking washer)