



# R180M Installation and Maintenance

**MASTER PNEUMATIC - DETROIT, INC.**

6701 -18 Mile Rd. | Sterling Heights, MI 48314 | Phone: (586) 254-1000 | Fax: (586) 254-6055 | Email: mp@masterpneumatic.com

## PRODUCT NUMBERS:

R180M-6  
R180M-8

## THANK YOU!

You have just purchased a quality Regulator from Master Pneumatic.

With care in its installation and maintenance, you can expect it to have a long and economical service life. Before you go any further, please take a few minutes to look over this information, then save it for future reference and for the useful service information it contains.

## Installation & Operation Procedures

### INSTALLATION:

1. Depressurize and lockout air pressure.
2. Upstream pipes must be free of excessive dirt and liquids.
3. Filters should be installed immediately ahead of Regulators to insure a clean supply of air.
4. Install the Regulator as near as possible to the device it is to serve.
5. Install the Regulator so that air flows from inlet to outlet as shown on the head.
6. The Regulator can be installed in any orientation.
7. The Regulator has gauge ports on both sides of the head. It is necessary to install a pressure gauge or pipe plugs into each port before operating.
8. Regulators should be installed upstream of any Lubricators in the airline.

### OPERATION:

1. When adjusting pressure setting, always reset from a pressure lower than the final desired setting. For example, lowering pressure from 100 psi to 50 psi should be done by decreasing pressure to 30 psi then increasing to 50 psi.
2. To increase pressure turn Adjusting Knob counter-clockwise, to lower pressure turn clockwise.
3. Pull out Adjusting Key for non-adjustment or remove for tamper proof.

### TO CLEAN OR REPAIR:

1. Depressurize and lockout air pressure.
2. Reduce Spring load to zero by turning Adjusting Knob counter-clockwise.
3. Remove Dome by turning counter-clockwise.
4. Piston can now be removed.
5. Remove Cap by turning counter-clockwise.
6. Valve Spring and Valve can now be removed.
7. When re-assembling, be sure all seals are correctly located. Torque Cap 50-60 in-lbs. Torque Dome 200 in-lbs.
8. If the Regulator cannot be repaired by cleaning with soap and water, the parts should be replaced.

## Replacement Parts

### Replacement Parts

| DESCRIPTION        | PART NUMBER |
|--------------------|-------------|
| Dome Assembly      | A37-02P     |
| Valve Assembly     | KA37-198B   |
| Adjusting Knob Kit | KA37-62     |
| Piston Kit         | KA37-200    |

### Mounting Accessories

| DESCRIPTION                      | PART NUMBER |
|----------------------------------|-------------|
| Panel Mount Nut & Bracket        | K37-71      |
| Panel Mount Nut                  | 37-32       |
| Gauge Port Wall Bracket          | KA37-68     |
| Gauge Port Extended Wall Bracket | KA37-68L    |



# R180M Installation and Maintenance

MASTER PNEUMATIC - DETROIT, INC.

6701 -18 Mile Rd. | Sterling Heights, MI 48314 | Phone: (586) 254-1000 | Fax: (586) 254-6055 | Email: mp@masterpneumatic.com

## Parts Listing

| KEY | DESCRIPTION     |
|-----|-----------------|
| 1   | Cap             |
| 2   | Valve Spring    |
| 3   | O-Ring          |
| 4   | O-Ring          |
| 5   | Valve           |
| 6   | Screw           |
| 7   | Valve Stem      |
| 8   | Pitot Tube      |
| 9   | Retainer        |
| 10  | O-Ring          |
| 11  | Head            |
| 12  | O-Ring          |
| 13  | Piston          |
| 14  | O-Ring          |
| 15  | Spring          |
| 16  | Dome            |
| 17  | Adjusting Screw |
| 18  | Spring Rest     |
| 19  | Nut             |
| 20  | Adjusting Knob  |
| 21  | Adjusting Key   |

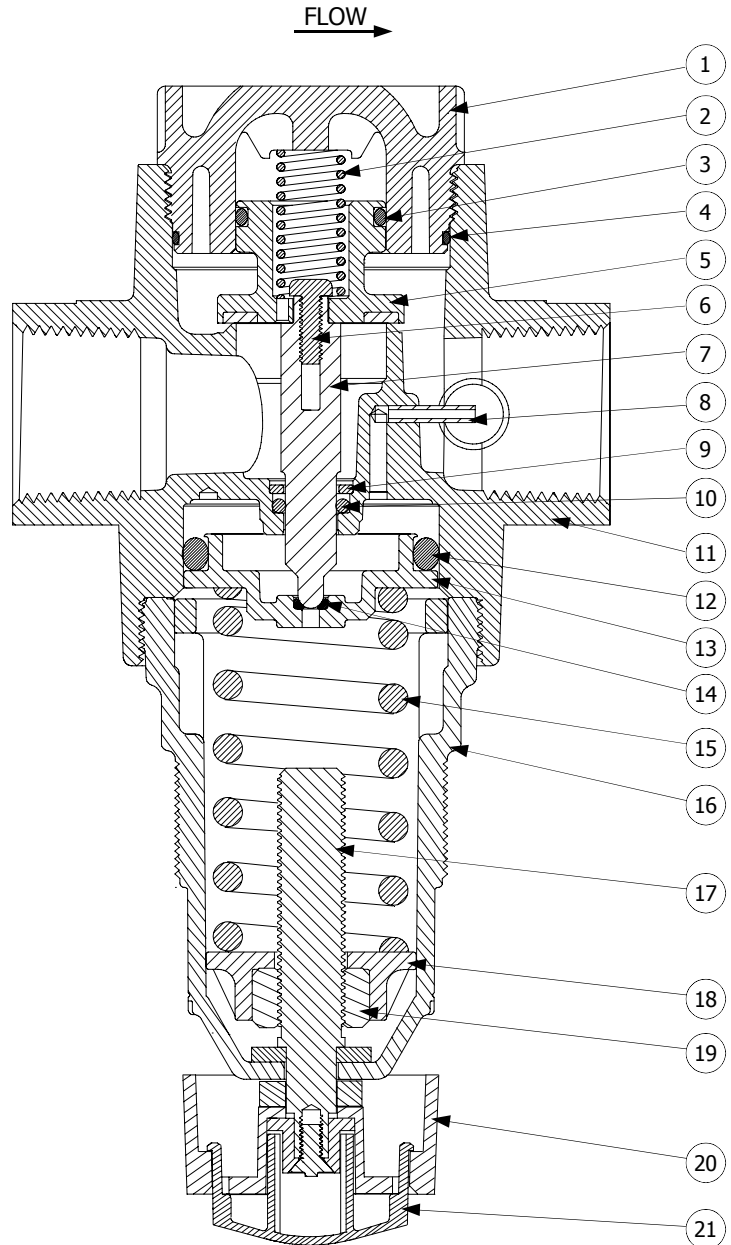



# R180M Installation and Maintenance

MASTER PNEUMATIC - DETROIT, INC.

6701 -18 Mile Rd. | Sterling Heights, MI 48314 | Phone: (586) 254-1000 | Fax: (586) 254-6055 | Email: mp@masterpneumatic.com

## Dimensional Specifications

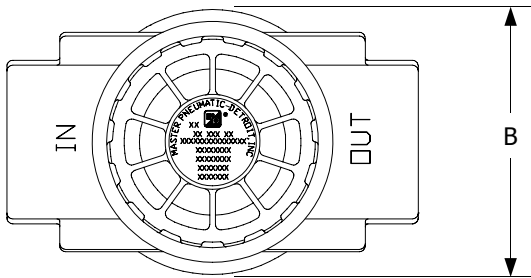

| KEY | DIMENSION          |
|-----|--------------------|
| A   | 4 7/16<br>(111 mm) |
| B   | 2 13/16<br>(71 mm) |
| C   | 2 1/2<br>(62 mm)   |
| D   | 6 1/8<br>(155 mm)  |

