



V380 Service Parts and Maintenance

MASTER PNEUMATIC - DETROIT, INC.

6701 -18 Mile Rd. | Sterling Heights, MI 48314 | Phone: (586) 254-1000 | Fax: (586) 254-6055 | Email: mp@masterpneumatic.com

Replacement Parts & Kits

THANK YOU!

You have just purchased a quality shutoff valve from Master Pneumatic.

With care in it's installation and maintenance, you can expect it to have a long and economical service life. Before you go any further, please take a few minutes to look over this information, then save it for future reference and for the useful service information it contains.

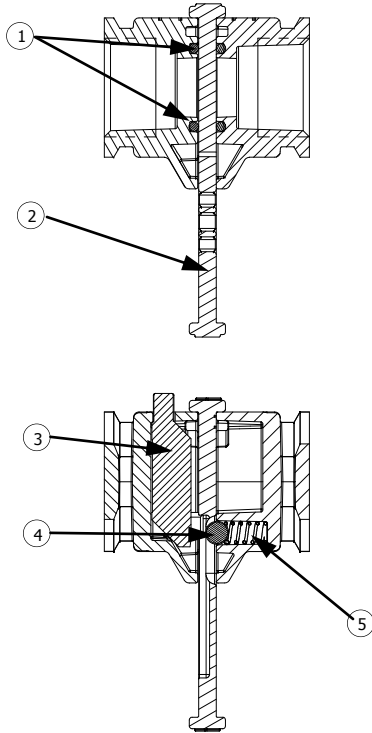

KEY	DESCRIPTION	V380-3	V380-4	V380-6
1	O-RING (QTY 1)	118-115	118-115	118-115
2	SLIDE	118-108	118-108	118-108
3	DETENT OVERRIDE LEVER	118-116	118-116	118-116
4	STEEL BALL	118-114	118-114	118-114
5	DETENT SPRING	456-10A	456-10A	456-10A

Dimensional Specifications

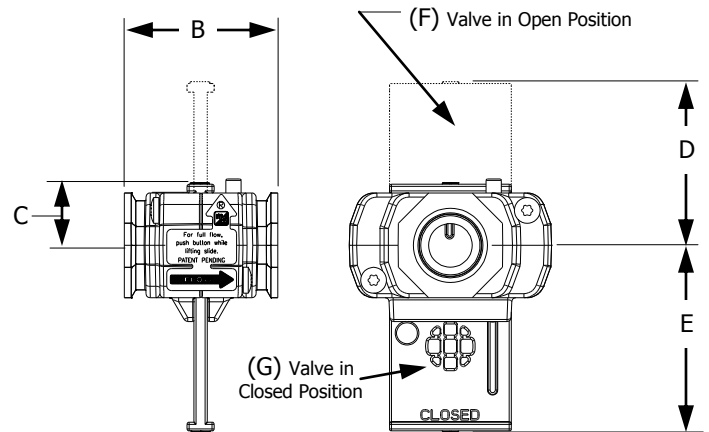
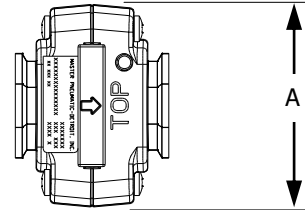

KEY	V380-3	V380-4	V380-6
A	2-29/32 (7.38 cm)	2-29/32 (7.38 cm)	2-29/32 (7.38 cm)
B	2-1/4 (5.72 cm)	2-1/4 (5.72 cm)	2-1/4 (5.72 cm)
C	29/32 (2.30 cm)	29/32 (2.30 cm)	29/32 (2.30 cm)
D (OPEN)	2-11/32 (5.95 cm)	2-11/32 (5.95 cm)	2-11/32 (5.95 cm)
E (CLOSE)	2-5/8 (6.67 cm)	2-5/8 (6.67 cm)	2-5/8 (6.67 cm)

Installation Procedures - Safety Lockout Valve

Installation:

Install the Safe-Start Valve in the airline following the directions of the arrow for airflow. The valve can only be locked in the closed position. A customer supplied padlock with a shank diameter less than .280 may be installed. The modular connection allows the valve to be mounted in any one of eight positions for greatest ease of operation.

Maintenance:

The slide may be lubricated on both sides for ease of movement. Manually move the slide up and down to lubricate internal parts.

Operating Instructions:

Slide Fully Extended (G): Inlet pressure is blocked, downstream air is exhausted to atmosphere. When locked in this position, the FRL may be safely removed and replaced without shutting down the main air supply. (The lockout valve cannot be removed off of air line).

Slide Inserted to Detent: The detent position guarantees that the safe-start position will not be bypassed. Inlet air is allowed to build up downstream air pressure safely, allowing parts to move into their normal working positions before full line pressure is applied.

Detent Button Pressed and Slide Fully Inserted: Full air pressure applied to downstream line. An override button is actuated while lifting the slide from soft-start position to the fully open position. Holding the override button down, while lifting the slide will go directly from the closed to the fully open position. Bypassing the slow start position.

Note: When installing two M/P products using the A115-105 connecting clamp or A118-05M Clamp and bracket, torque screws 30-40 in-lbs maximum.